

Installation Manual

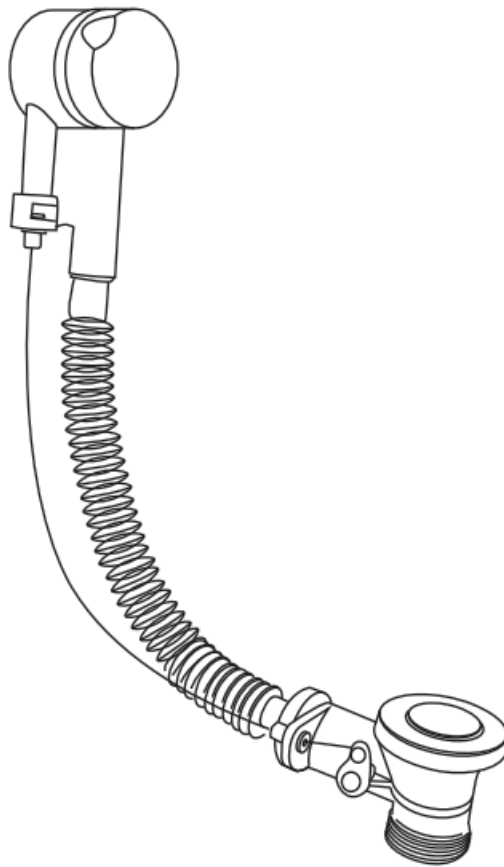

Apply for following models
55028/55029

Please keep this page for your online registration.

No.FIACBRB03V1.0



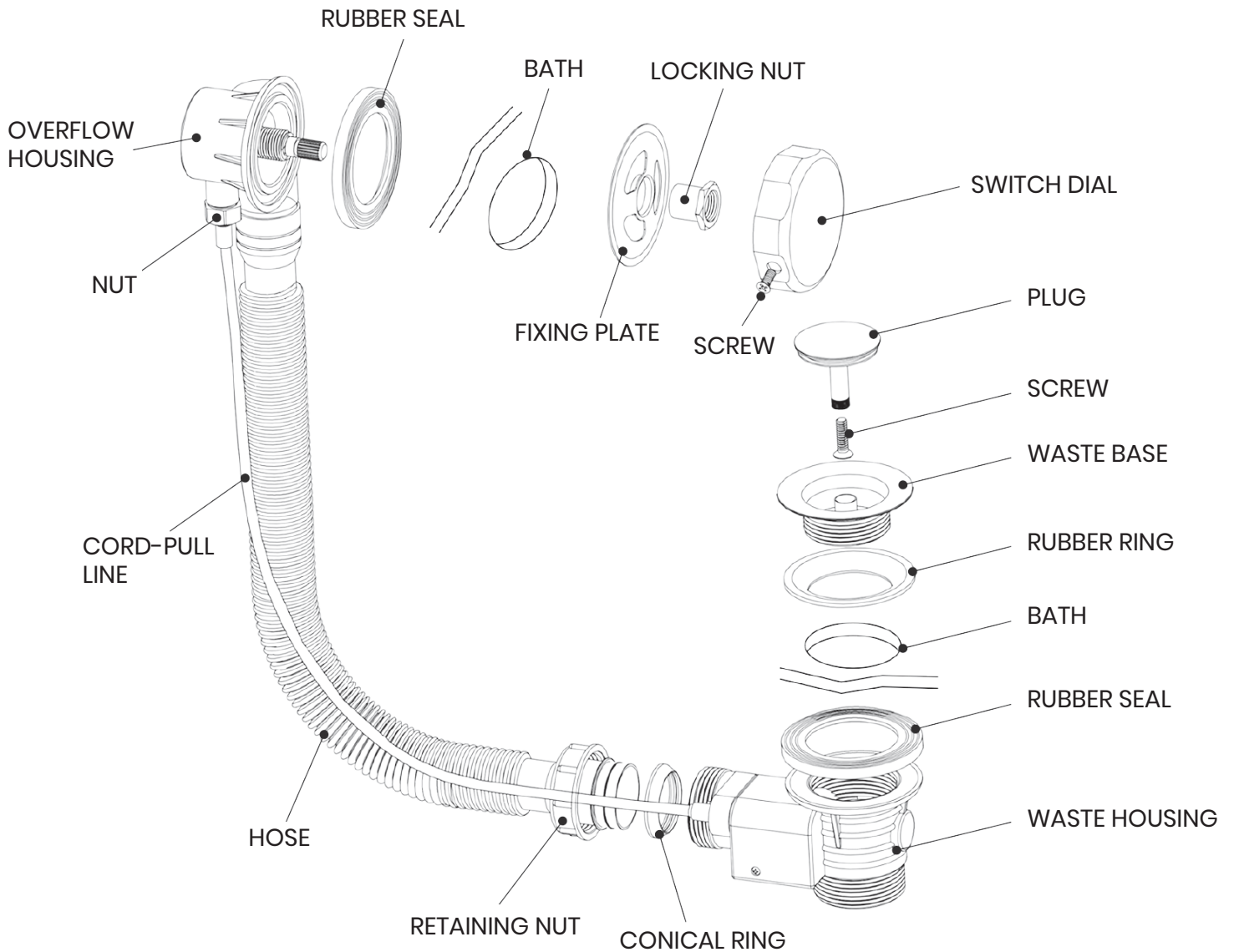

To Fit The Overflow:

Fit the rubber seal into the housing and position on the outside of the bath. From the inside of the bath place the fixing plate over the overflow hole and screw the nut in through the plate & tighten in position. Fit the dial over the thread and lock in place by tightening the small screw.

To Fit The Waste:

Fit the rubber seal onto the housing and position over the waste hole under the bath. From inside the bath push the rubber ring onto the base and screw the base into the housing through the bath. Adjust the screw in the bottom of the plug to enable the waste to open and close with the switch dial as required.