

# Installation Manual

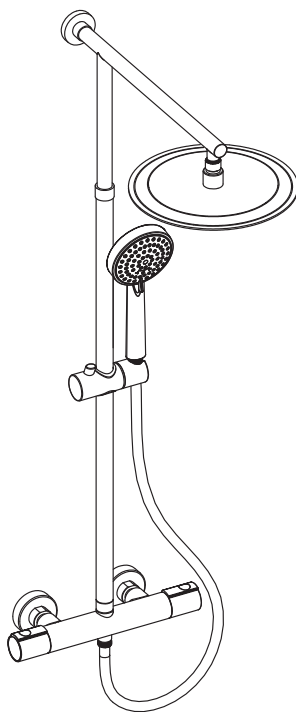

Apply for following models

**23009/23014**

Please keep this page for your online registration.

No. FISHTBX06V1.0



| Contents                        | Page  |
|---------------------------------|-------|
| Dimension Picture               | 03    |
| Spare Parts List                | 04    |
| Tool List                       | 05    |
| Temperature Condition For Mixer | 05    |
| Installation                    | 05-11 |
| Operation                       | 12    |
| Temperature Setting             | 13    |
| Trouble Shooting                | 14    |

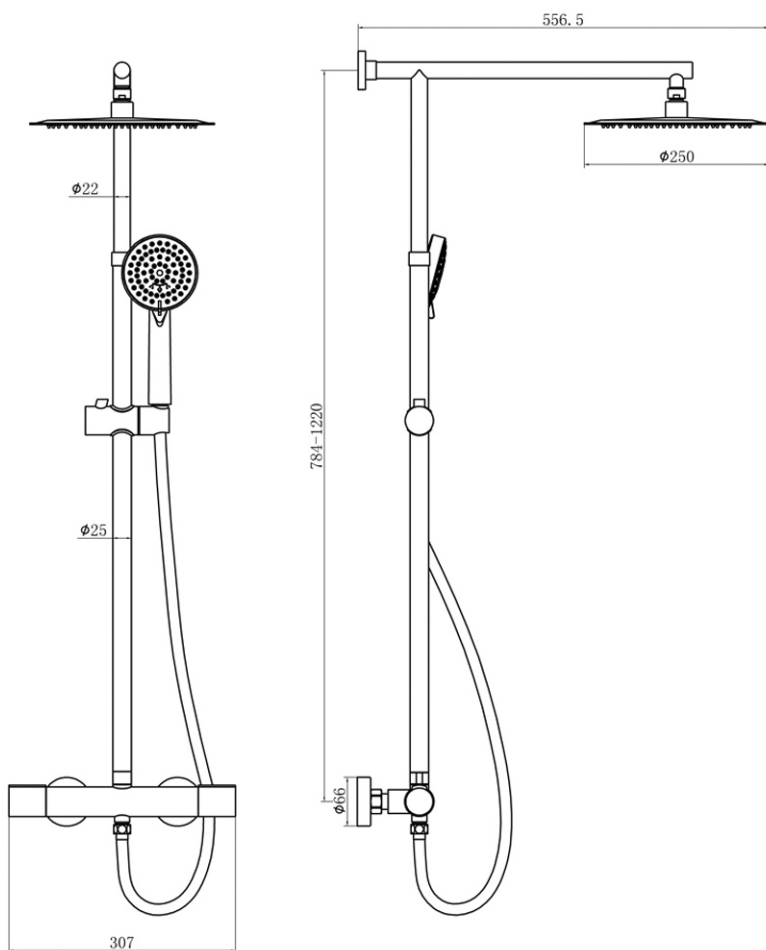

## Spare parts list



[01]x1



[02]x2



[03]x2



[04]x2



[05]x1



[06]x2



[07]x2



[08]x1



[09]x1



[10]x1



[11]x1



[12]x1

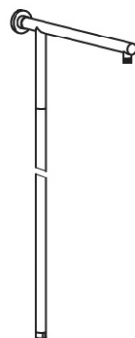

[13]x1

| ARTICLE | DESCRIPTION           | QTY |
|---------|-----------------------|-----|
| 1       | Mixer Body            | 1   |
| 2       | Pipe Connectors       | 2   |
| 3       | Wall Plate Covers     | 2   |
| 4       | Rubber Washer         | 2   |
| 5       | Rubber Washer         | 1   |
| 6       | Wall Plug             | 2   |
| 7       | Screw                 | 2   |
| 8       | Allen Key             | 1   |
| 9       | Wall bracket          | 1   |
| 10      | Hand Held Shower Head | 1   |
| 11      | Fixed Shower Head     | 1   |
| 12      | Shower hose           | 1   |
| 13      | Riser Rail            | 1   |

## Tool list

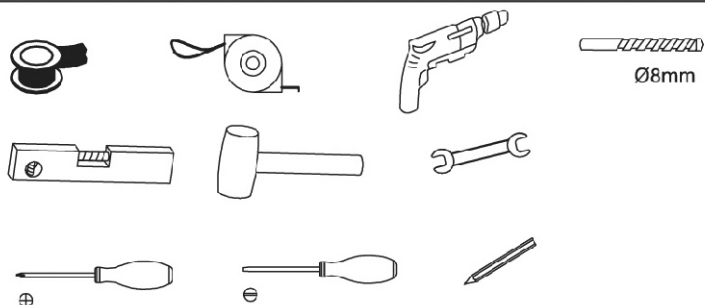

## Conditions of use for thermostatic mixer vales

|                             | Low Pressure             | High Pressure            |
|-----------------------------|--------------------------|--------------------------|
| Max Static Pressure (Bar)   | 10                       | 10                       |
| Flow Pressure Hot&Cold(Bar) | 0.1-1.0                  | 0.5-5.0                  |
| Hot Supply Temperature(°C)  | 55-65                    | 55-65                    |
| Cold Supply Temperature(°C) | Equal to or less than 25 | Equal to or less than 25 |

## Installation

Step ①

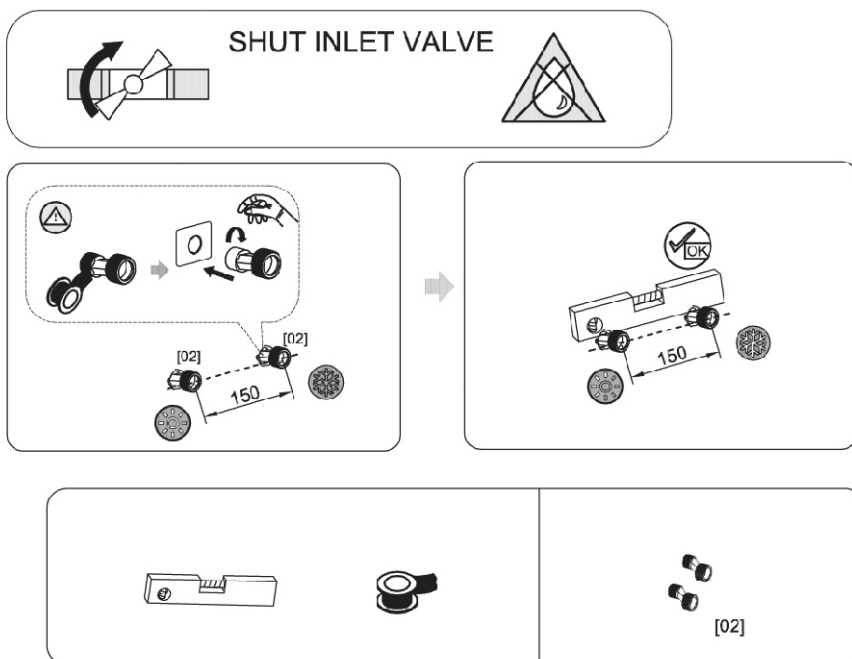

2

Pipework should be flushed through before attaching the mixer body to prevent debris from going into the mixer

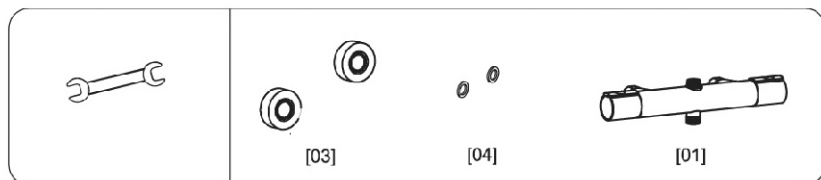
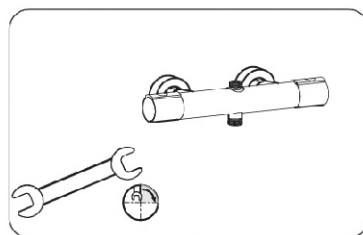
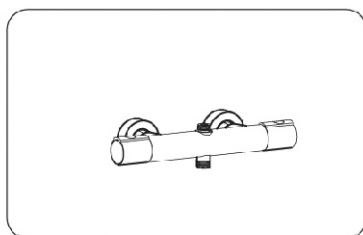
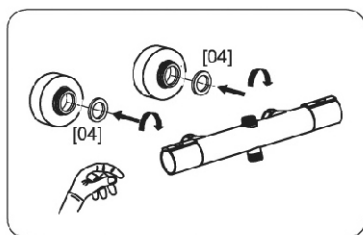
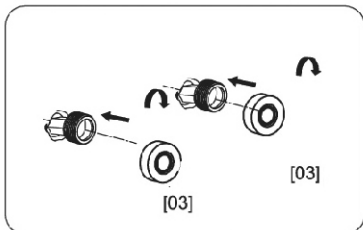

3

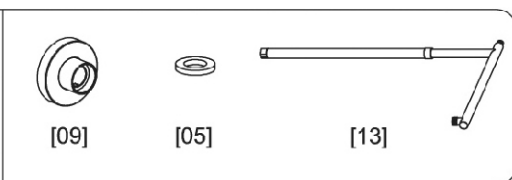
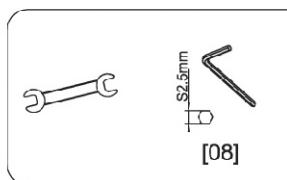
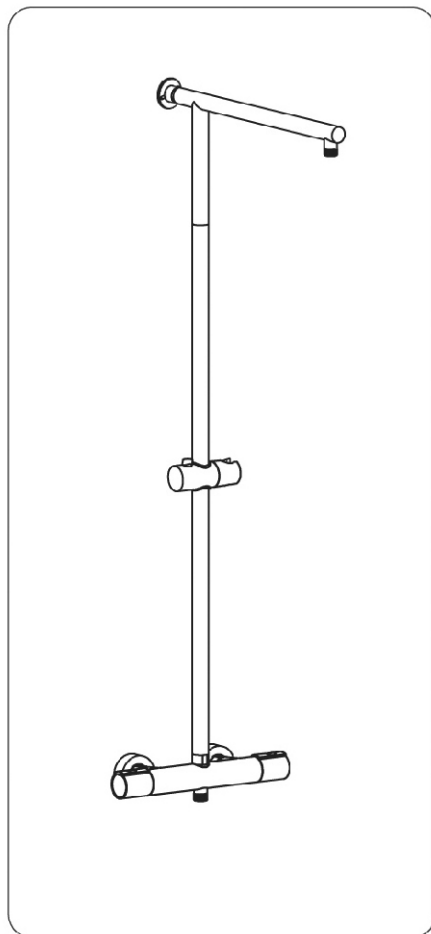
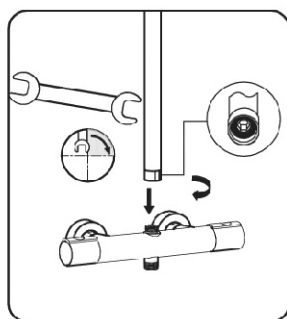
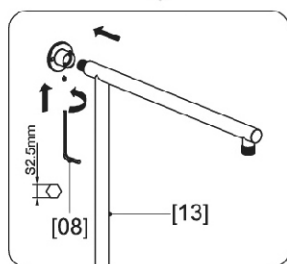
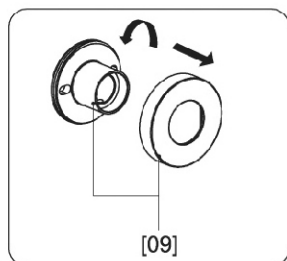

4

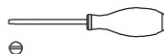
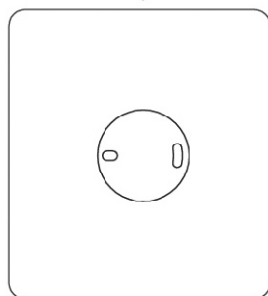
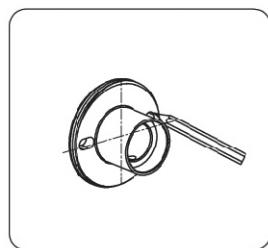
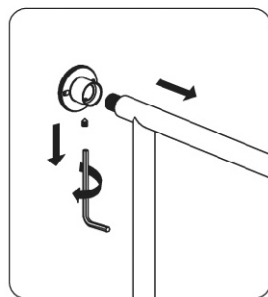
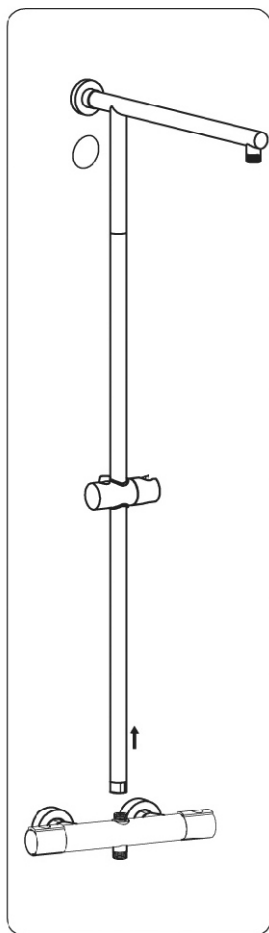
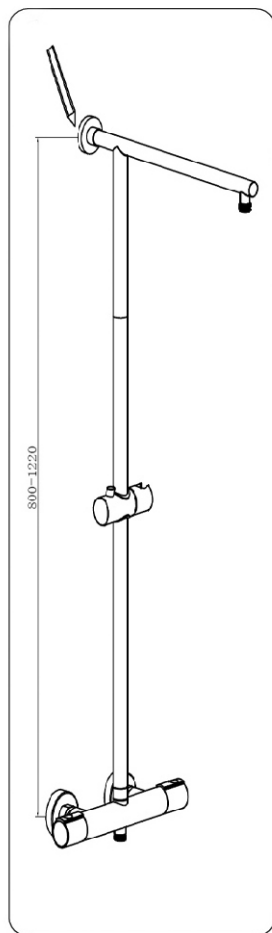

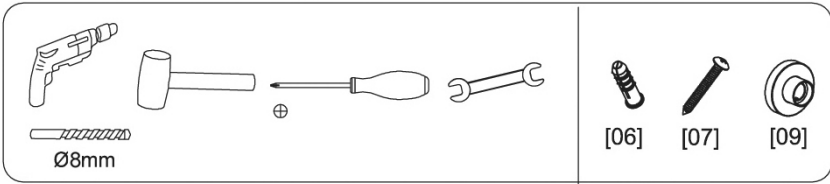
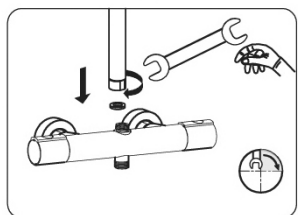
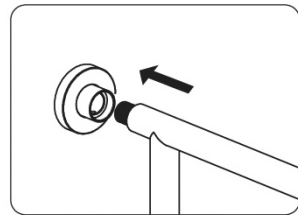
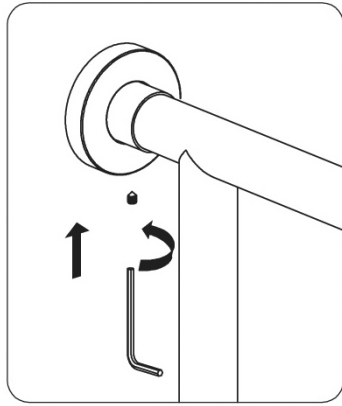
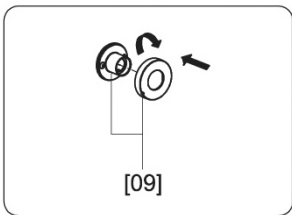
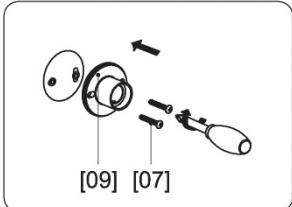
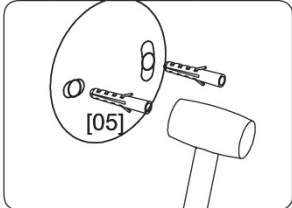
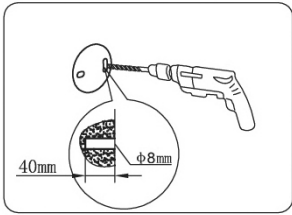

6

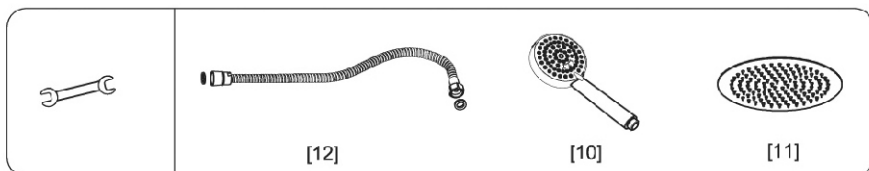
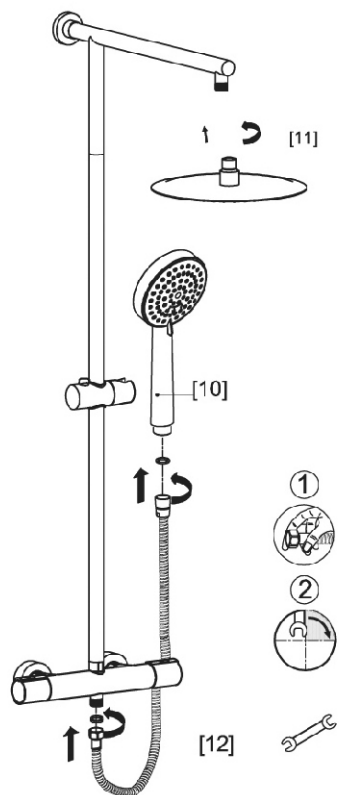

7

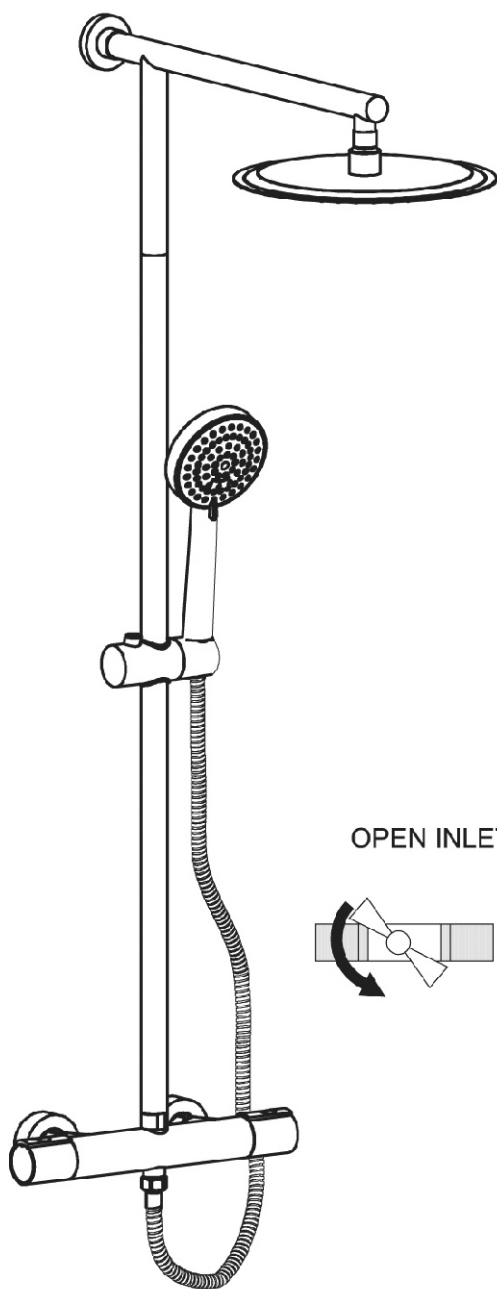

OPEN INLET VALVE

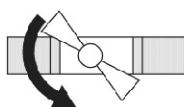

## OPERATION

Turn the Function shift handle to turn on top head shower or handle shower and to increase/decrease the flow of water. Turn the Temperature control handle to increase/decrease the temperature. Push down on the Override button and turn the handle towards you to override the set temperature.

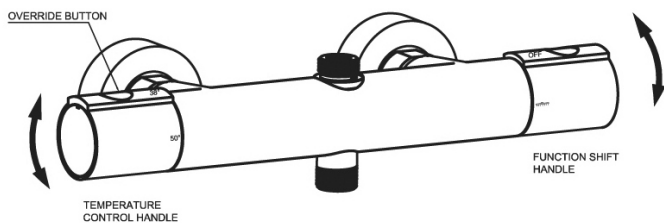

## TEMPERATURE SETTING

Removing the handle - pull off the cap and remove the washer & screw, pull off the handle/cover.

Rotate the exposed thermostatic spindle (clockwise for cold, and anti-clockwise for hot) until the maximum desired showering temperature is set (38°C - suggested maximum "pre-set" temperature).

Then line up the button on the top of the handle/cover with the stop on the stop ring itself. Push the handle/cover onto the splines, tighten the screw, refit the cap.

The thermostat is now set to its new temperature and can only be increased or decreased by repeating this process.

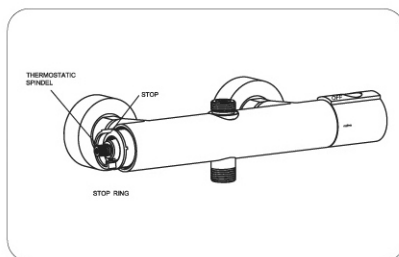
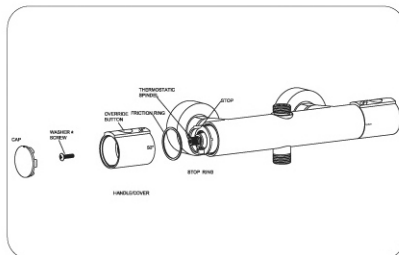

## TROUBLE SHOOTING

| SYMPTOM   | SOLUTION  |
|---|---|
| After installation the shower/bath runs HOT or COLD and will not mix. | Hot and cold supplies are plumbed the wrong way round.                                      |
| Shower/bath will not run hot enough when first installed.             | Maximum temperature needs adjusting, see 'temperature setting'.                             |
| Cold water tracking through the valve into the hot water system.      | Check and clean the filters.  |
| Very low flow or no flow (gravity).                                   | Check hot and cold feeds (the valve will shut down if either the hot or cold supply fails). |

This product should only be fitted by a qualified plumber to NVQ (National Vocational Qualification) or SNVQ (Scottish National Vocational Qualification) Level 3. Should the installation be completed by a non-qualified person then the guarantee may be considered invalid.

For a claim made under our warranty written certification of your installers credentials can be required. For further information or to find a qualified installer in your area please visit the Institute of Plumbers website - [www.iphe.org.uk](http://www.iphe.org.uk)