

Installation Manual

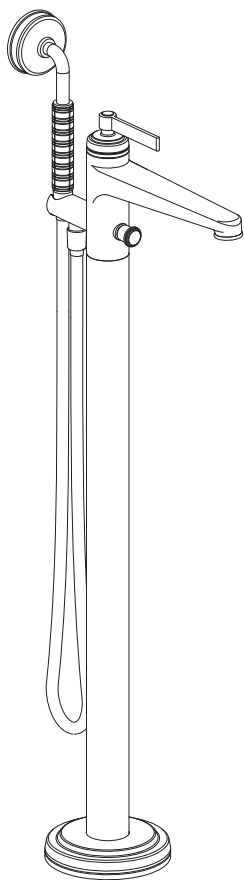

Apply for following models

12235/12236/12237

Please keep this page for your online registration.

No. FIBTTBK08V1.0



WARNING



CAUTION

If using solder for the installation of the tap; the tap seats, cartridges and washers will have to be removed before heating. Otherwise, the warranty will be voided on these parts.

TOOLS YOU MIGHT NEED

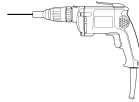

Electric Drill



Wrench24



Wrench10



Pencil

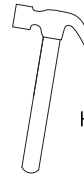

Hammer

TECHNICAL DATA

Recommended water pressure: 14.5 - 72.52 psi

Max. Water pressure: 145 psi

Recommended hot water temp: $\leq 149^{\circ}\text{F}$

Max. Hot water temp: 194°F

Please know and follow all applicable local plumbing codes when setting the temperature on the water heater.

PARTS LIST

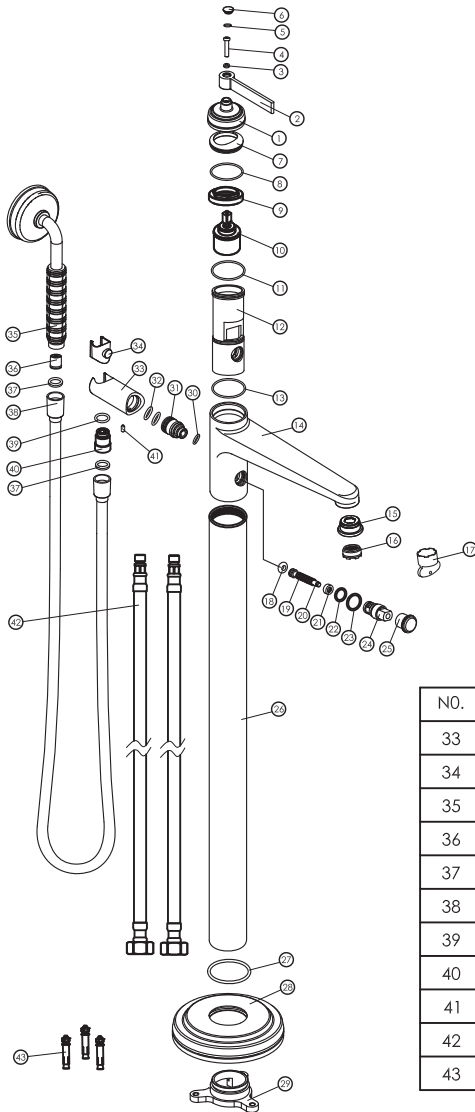

NO.	DESCRIPTION
1	HANDLE BODY
2	HANDLE BAR
3	O RING
4	SCREW
5	O RING
6	CAP
7	COVER
8	O RING
9	NUT
10	CARTRIDGE
11	O RING
12	CORE
13	O RING
14	BODY
15	AERATOR SHELL
16	AERATOR
17	AERATOR WRENCH
18	O RING
19	SPRING
20	LIFT BAR
21	GASKET
22	O RING
23	O RING
24	LIFT BODY
25	LIFT HANDLE
26	PIPE
27	O RING
28	COVER
29	BASE
30	O RING
31	JOINT
32	O RING
33	SHOWER HOLDER
34	PROTETIVE SLEEVE
35	HAND SHOWER
36	CHECK VALVE
37	WASHER
38	HOSE
39	GASKET
40	JOINT
41	SCREW
42	FLEXBLE HOSES
43	SCREWS

BEFORE INSTALLATION

- ⌘ Observe all local plumbing codes.
- ⌘ Make sure water supply is turned off.
- ⌘ Read these instructions carefully to ensure proper installation.
- ⌘ Cover your drain to avoid losing parts.
- ⌘ Check to make sure you have the following parts indicated below.



Please check you have all of these items in the box.



Body

X1



Hand Shower

X1



Shower Hose

X1

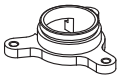

Base **X1**



Cover **X1**



Washer **X2**



Screw **X3**

INSTALLATION PROCEDURE

1

Slide the decorative cover over the product pipe. Screw the base onto the pipe threads.

Including the thickness of tile

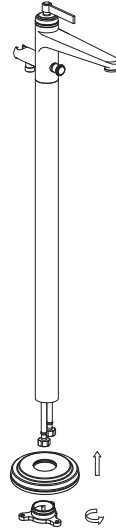
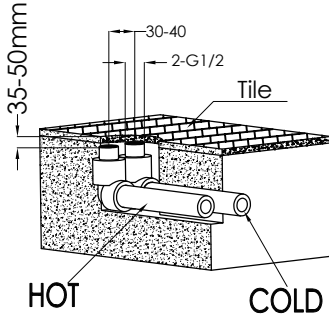

2

Mark the installation position, drill holes, and insert plugs. Unscrew the mounting nuts from the bolts.

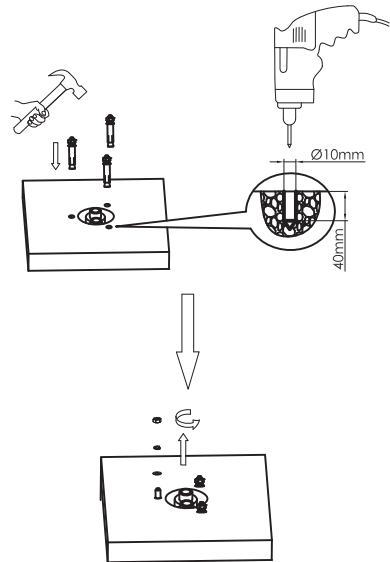
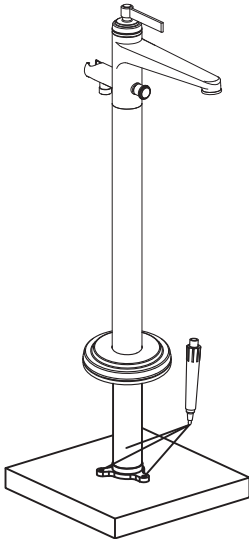

INSTALLATION PROCEDURE

3

Connect the flexible hoses to pipes, secure the product base to the floor with the bolts, then tighten the mounting nuts.



Before connecting to the mains any new pipework should be flushed through to remove any debris that may clog the cartridge in the tap.

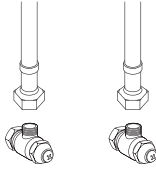

↑
CONNECT
WITH
HOT WATER PIPE

↑
CONNECT
WITH
COLD WATER PIPE

4

Connect the shower hose to the hand shower and the product, put washers at both ends.

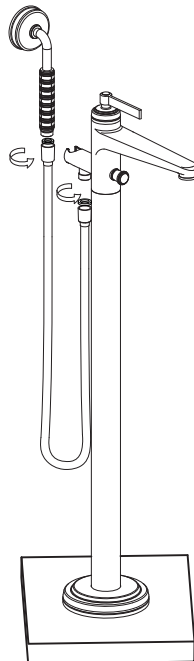
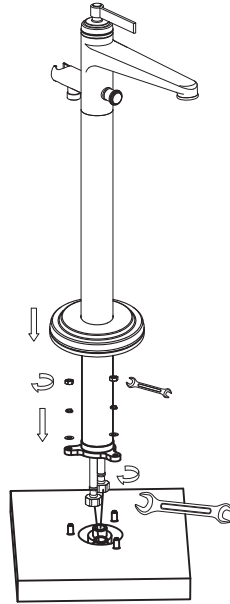

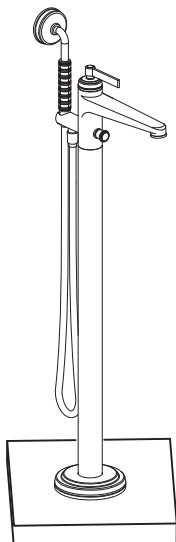

AFTER INSTALLATION

Ensure that all connections are tight. Ensure that the handle is in the off position. Turn on the drain and main water supply, and check for leaks. Repair as needed.

CARE & CLEANING

Your new tap is designed for years of trouble-free performance. Keep it looking new by cleaning it periodically with mild soap, rinse thoroughly with warm water and dry with a clean, soft cloth. Do not use abrasive cleaners, steel wool or harsh chemicals, as these will dull the finish. Failure to follow these instructions may void your warranty.

TROUBLE SHOOTING

If you've followed the instructions carefully and your tap still does not work properly, take these corrective steps.

Problem	Possible Cause	Solution
Insufficient water	- Aerator clogged	- Clean aerator, replace if necessary
Mixer stiff	- Cartridge defective	- Replace cartridge
Mixer dripping	- Cartridge defective	- Replace cartridge
Water leaks below handle	- Cartridge defective	- Replace cartridge
	- O-ring/rings defective	- Replace O-ring/rings
Water leaks at the connections hose	- Connection hose defective	- Replace connection hose
	- O-ring at the connection hose defective	- Replace O-ring
	- Cartridge adapter defective	- Replace cartridge adapter
	- Cartridge adapter O-ring defective	- Replace O-ring