

# Installation Manual

Apply for all cabinets.

Please keep this page for your online registration.

FIFUMCO03V2.0

## Important Notes — Before drilling

- Place the product in a well-ventilated environment to prevent oxidation due to long-term humidity.
- Check for any hidden cables or pipes in the wall.
- Measure the distance between the "top mounting holes" and "bottom mounting holes" from the back of the unit before drilling.
- Use a ceramic drill bit if drilling through tile.
- If uncertain about the appropriate wall plugs for your wall, consult a professional or qualified tradesperson.
- Do not use nails to mount the cabinet.
- If the wall surface has irregularities, it might cause distortion of the cabinet body when mounted. Use shims between the cabinet and wall if necessary.

You will need the tools below to assemble the products

(Tools not provided).

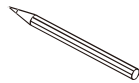
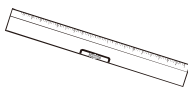

## I Preparing the Cabinet

1. Gently unpack the cabinet, setting aside the hardware package and doors for later use.

## II Determining the Installation Location

1. The recommended height for mirror cabinets is 64 inches from the finished floor to the center of the mirror area. However, adjust this height to fit your personal preference.
2. For the highest stability, attach the cabinet directly to the wall studs.

## III Mounting the Cabinet

**NOTE: We recommended getting assistance from one or two others to simplify the installation process .**

1. Measure and mark four mounting holes on the wall, aligning with the pre-drilled hole locations in the cabinet's mounting bars located on the inside back panel.

2. (FIG1) Draw horizontal lines connecting the top two and bottom two marks, ensuring they are level. Repeat this process for the vertical lines connecting the left and right marks. Ensure the marks are level, and that the cabinet's mounting holes align with the marked locations on the wall.

3. Drill 1/4" diameter holes at the marked locations on your wall. If these holes do not align with a stud, increase the hole diameter to fit wall anchors. Position these anchors as necessary.

4. Position the cabinet in place and ensure it's level.

5. Secure the cabinet to the wall using the four mounting screws provided in the hardware pack.

**FIG1**

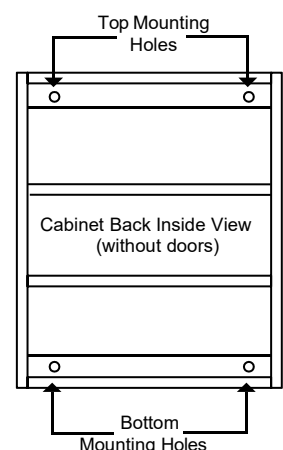

## IV Door Adjustment

**NOTE: This step applies only if the cabinet's mirror doors are uneven by up to 0.5mm.**

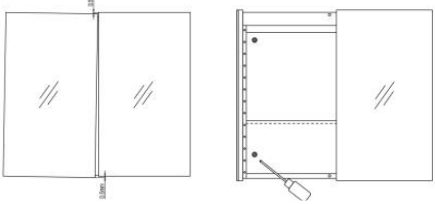
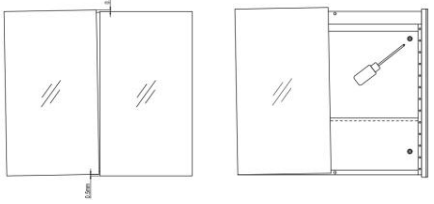
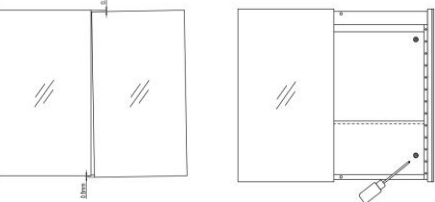
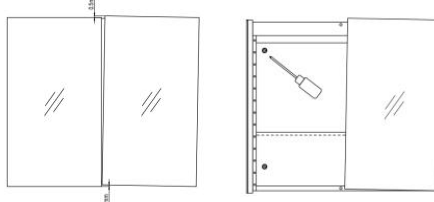
<p>1)</p>  <p>If the left door is lower than the right, slightly loosen the installation screws on the inclined door by 0.5-1mm.</p>	<p>2)</p>  <p>If the left door is higher than the right, slightly loosen the installation screws on the right door by 0.5-1mm.</p>
<p>3)</p>  <p>If the right door is lower than the left, slightly loosen the installation screws on the inclined door by 0.5-1mm.</p>	<p>4)</p>  <p>If the right door is higher than the left, slightly loosen the installation screws on the inclined door by 0.5-1mm.</p>

## V Operating the Touch Sensor Switch

**NOTE: Cabinet with front touch switch, the LED light on as switch on, LED light off as switch off.**

**The left touch button is used to control the mirror light and the heated demister pad.**

1. Tap once to turn on the mirror light (cool white LED color temperature) and the heated demister pad.
2. Tap again to adjust LED color temperature to natural light, while keeping the heated demister pad on.
3. A third tap adjusts LED color temperature to warm white, keeping the heated demister pad on.
4. A fourth tap turns off the mirror light and heated demister pad.

**The right touch button is used to control the bluetooth speaker.**

1. Tap to turn on / off the bluetooth speaker.

## VI Operating the Touchless Infrared Sensor Switch

1. To adjust the color temperatures between cool white and warm white, hold your hand near the infrared sensor for a few seconds (at a distance of about 5cm).
2. To turn on the light, heated demister pad and bluetooth speaker, move your hand near the infrared sensor.
3. To turn them off, bring your hand close to the sensor again.

## VII Operating the Bluetooth Speakers

1. Turn on the power, the Bluetooth speakers issued a standby signal sound, Bluetooth speakers now is in status of standby pairing.
2. Open the phone's Bluetooth function and search attachment equipment, until the mobile phone search to the device name "Mirror Cabinet xxx". After the pairing connection, the Speakers make a sound means the successful connection of the Bluetooth speaker.
3. If you want to disconnect from the blue tooth speaker. Just turn off the Bluetooth function of the phone. When a sound is heard, the speaker is disconnected and returns to standby pairing mode.