

# Installation Manual

Please keep this page for your online registration.

No. FIRDRA04V1.0





#### CAUTION

1. Follow installation instructions carefully to ensure unit is properly attached to the wall.
2. To avoid a possible fire hazard, it is essential unit is mounted in accordance with guidelines stated in the instruction.
3. Radiator is intended for indoor use only, do not place radiator inside a shower, steam room, or wherever unit would be exposed to water.

## TECHNICAL DATA

It should only be filled with water, and at a temperature below  $100^{\circ}\text{C}$  ( $212^{\circ}\text{F}$ ). See table below for installation requirements. If the temperature exceeds  $48^{\circ}\text{C}$  (or  $120^{\circ}\text{F}$ ), please install a warning sign near the product to avoid burning and scolding accidents.

Temperature:  $0^{\circ}\text{C} < t \leq 100^{\circ}\text{C}$

Comments: If ambient temperature drops below  $1^{\circ}\text{C}$ ,  
drain out the water to prevent freezing.

#### Important

Wipe the surface clean with a soft, damp cloth. Never use abrasive cleaners on this product as they will damage the surface.

## TOOLS YOU MIGHT NEED

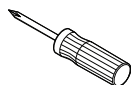

Screwdriver



Pencil



Adjustable Wrench

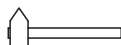

Rubber Hammer



Glove



Tape Measure



Spirit Level

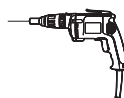

Electric Drill



Clean Cloth

## IMPORTANT CHILD SAFETY NOTE

**Important:** Please note that you are 100% legally responsible for your own child's safety at home. Once the radiator is installed, it can become a hazard for children as a) This radiator is not designed to support unreasonable extra weight, such as that of a child, and b) The radiator becomes hot during use. Due to this, we must stress that you should not allow children to climb/grab/play with the radiator or rails, as this can cause accident or injury for the child, from heat, falling, or the radiator being pulled off the wall.

### BEFORE INSTALLATION

- Observe all local plumbing and building codes.
- Shut off the main water supply.
- Read these instructions carefully to ensure proper installation.
- Check to make sure you have the following parts indicated below.



**CAUTION**

**Please check you have all of these items in the box.**

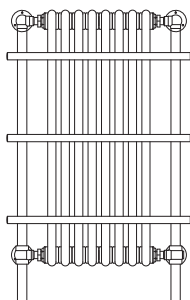

**Body  
X1**

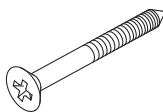

**Long Screw  
X12**

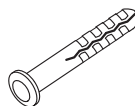

**Masonry Wall Plug  
X12**

# INSTALLATION PROCEDURE

1

Mark the hole position on the wall.

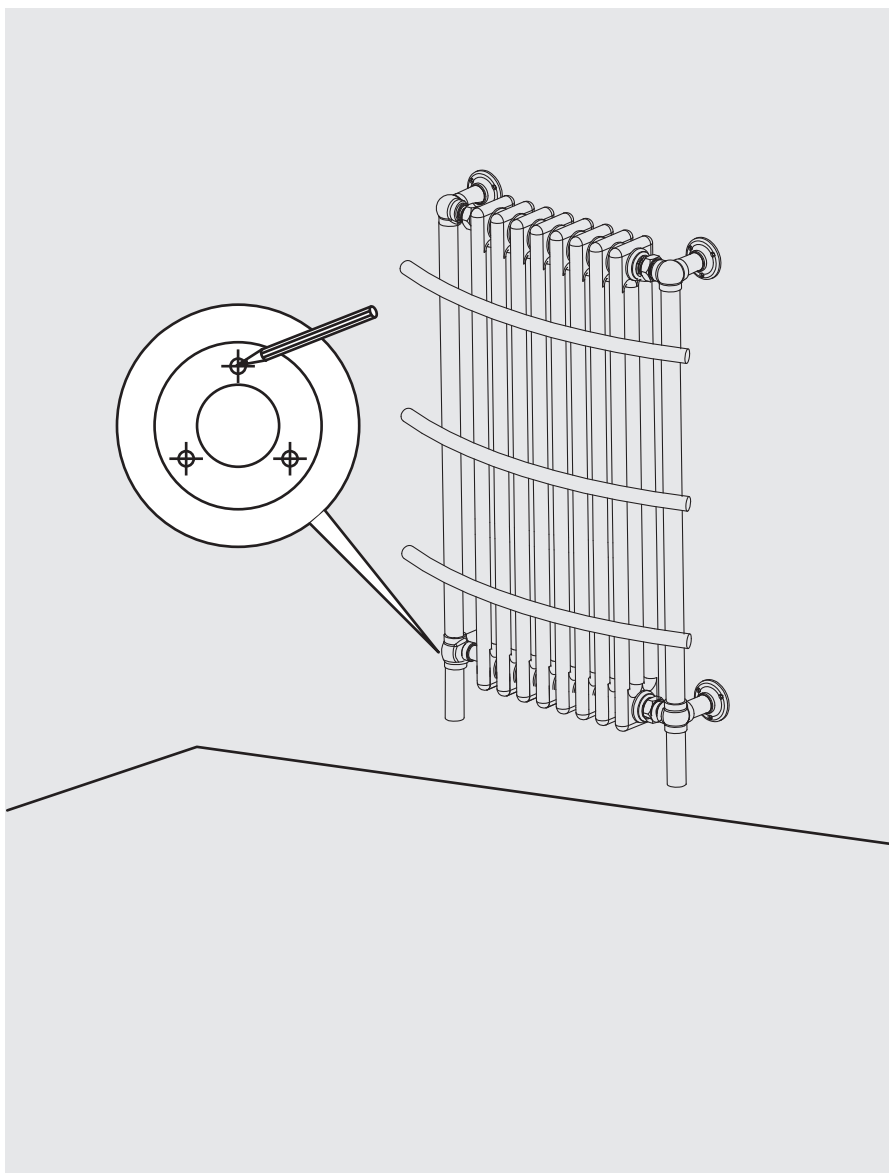

## INSTALLATION PROCEDURE

2

Drill the holes of 8mm diameter, accordingly with the same depth of the masonry wall plug, put the masonry wall plug into the hole.

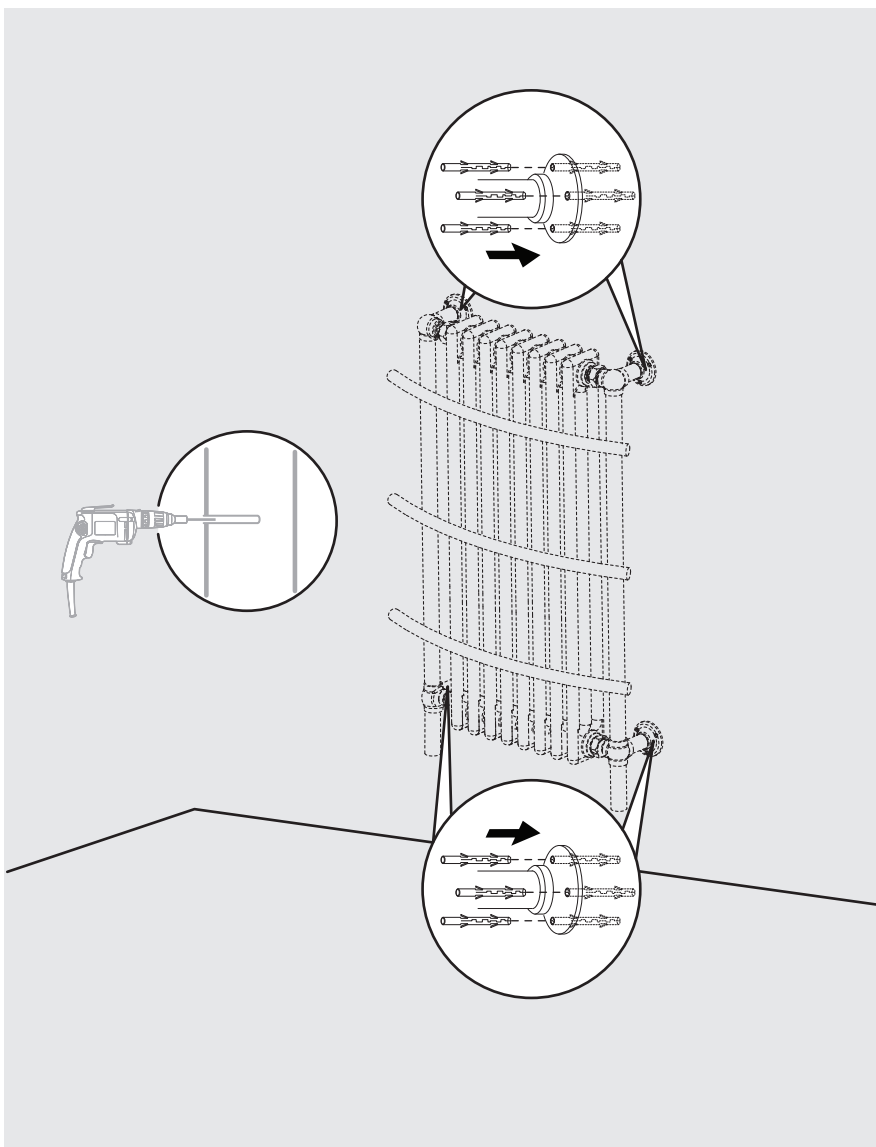

## INSTALLATION PROCEDURE

**3**

Tight the wall bracket with screw in the wall (note:don't tight completely in order to adjust the position later.)

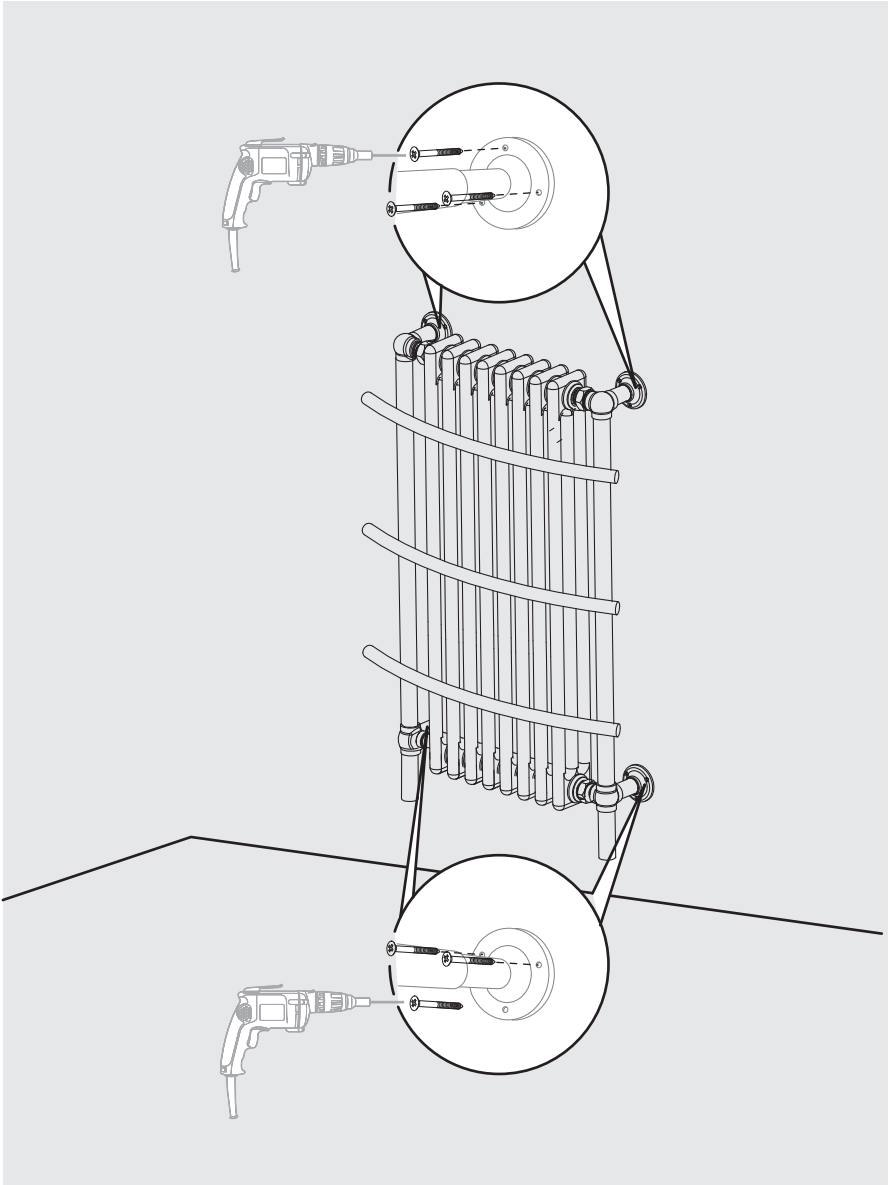

## INSTALLATION PROCEDURE

4

Use allen key to connect wall bracket and towel warmer with M5 screw,adjust the position to match all the hole position marked,the tight all the acrew.

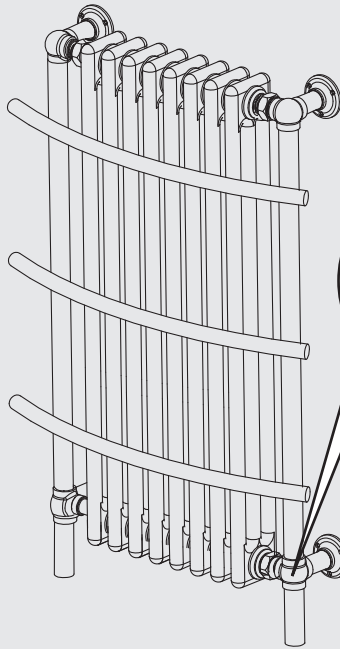

screw plug



**ATTENTION:**if here has this screw plug.This radiator is available in both hydronic&electric heating.If you choose hydronic heating, cross screw as above has to be firmly tightened to avoid any leakage.For electric heating, just connect the heat element to the radiator, and tighten it with a wrench.If here has not the screw plug, only hydronic heating use.

## INSTALLATION PROCEDURE

5

Wind the PTFE tape on the radiator valve thread, tighten the valve into the bottom two threaded hole by spanner.

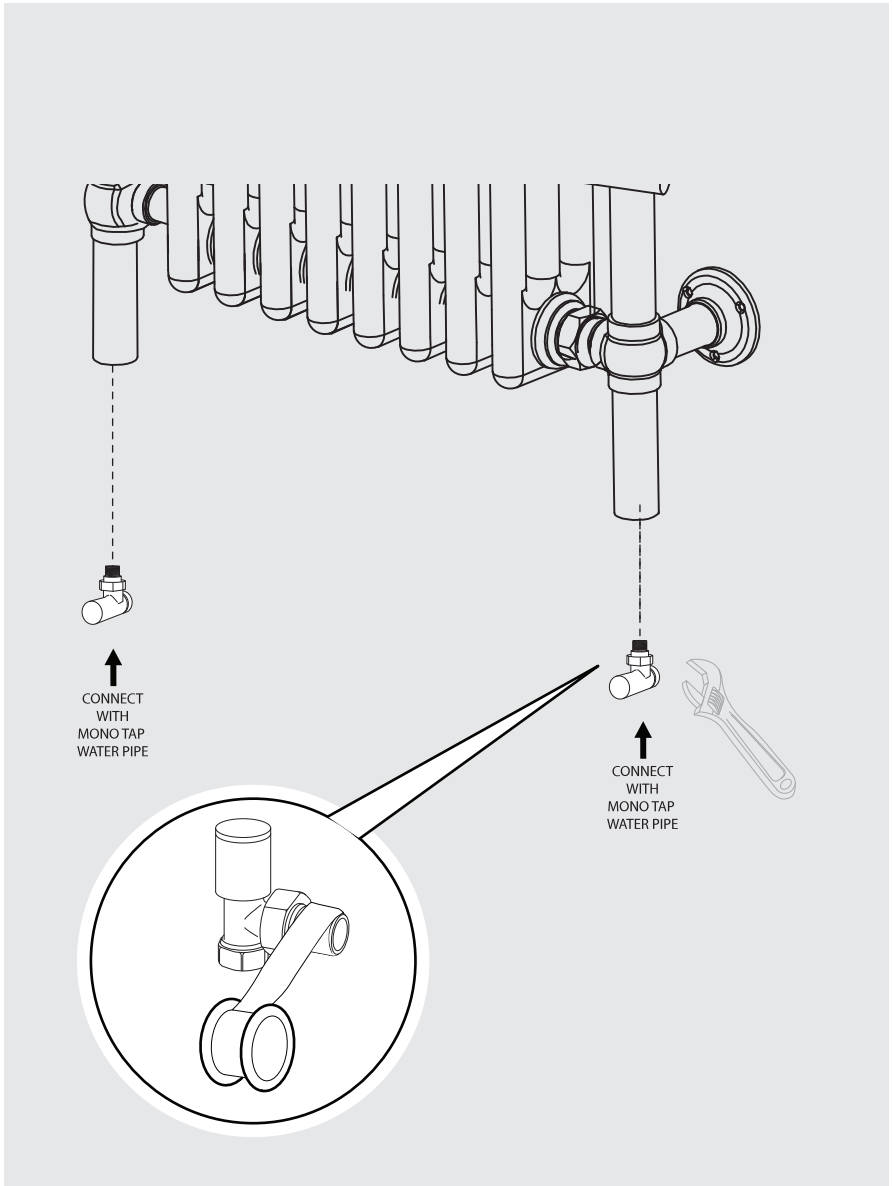



**Connect valves to household system, turn on water and bleed the radiator to fill with water.**

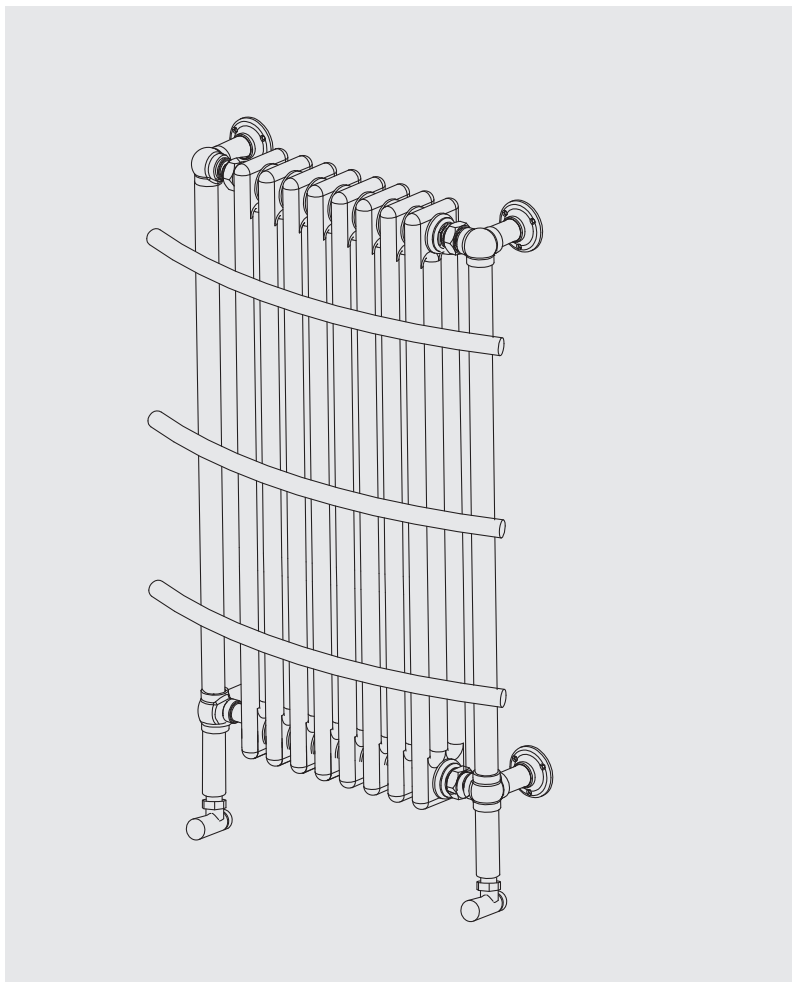

**Note: Top up your system with inhibitor fluid after installation**

## AFTER INSTALLATION

Use a screwdriver to open the air vent,open the valve and let the water rush into radiator.

Check all connection for leaks.

Once water overflows from the air vent,there is no air in the tube.

Use a screwdriver to close the air vent,turn on the valve and the radiator is ready for use.

## CARE & CLEANING

Radiators are made from steel and should not be cleaned with corrosive or scouring cleaning agents.

## TROUBLE SHOOTING

When your radiator doesn't function, knowing basic radiator troubleshooting can save you from the stress and the hassles of a non-functioning radiator. Here is a guide to solve the most common problems associated with these electric home heaters.

Problem	Cause	Action
Cold spots on the radiator unit	-Water is not flowing through radiator properly	1.Check to make sure there is no trapped air inside the radiator. "Bleed" the radiator to release air. 2.Make sure the valve is fully open to allow water to run freely. Some radiator may need diverter for water to flow properly around the unit.
Leak on the radiator	-Valve nut is loose -Welding problem	-Tighten the valve nut -Replace radiator
Sound of whistling or water whooshing	-Radiator was not properly balanced when it was installed	-Re-install
Clanking sound	-The radiator was installed in a space that doesn't allow for pipe expansion	-Re-install